

SCHLAUCHTÜLLEN BSPP EN ISO 228-1
HOSE NIPPLES British Standard Pipe Parallel

BETRIEBSDRUCK	1,0 MPa (10 bar)
EINBAND	Schlauchschelle
DICHTUNG	PTFE (Standard)
WORKING PRESSURE	1,0 MPa (10 bar)
ASSEMBLING	swage ferrule, safety clamp
GASKET	PTFE (standard)



Schlauchtülle - Überwurfmutter
 hose nipple - adjustable nut



Schlauchtülle
 hose nipple

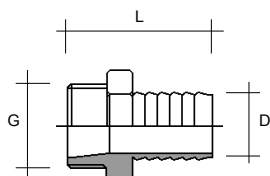

zylindr. Außengewinde / parallel thread

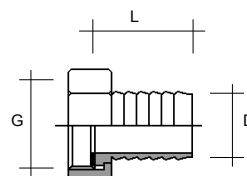

flachdichtend / flat sealing

Edelstahl / stainless steel 1.4571

Schlauchtülle / hose nipple

Schlauchtülle - Überwurfmutter fld. / hose nipple - adjustable nut

G BSPP	L mm	D mm	Art.-Nr.	G BSPP	L mm	D mm	Art.-Nr.
G 1/4"A	40	8	808-412.008002	G 1/4"	31	8	808-402.008002
G 1/4"A	40	10	808-412.010002				
G 3/8"A	40	8	808-412.008003	G 3/8"	31	8	808-402.008003
G 3/8"A	45	10	808-412.010003	G 3/8"	40	10	808-402.010003
G 3/8"A	45	13	808-412.013003				
G 1/2"A	45	8	808-412.008004	G 1/2"	32	8	808-402.008004
G 1/2"A	45	10	808-412.010004	G 1/2"	43	10	808-402.010004
G 1/2"A	50	13	808-412.013004	G 1/2"	43	13	808-402.013004
G 1/2"A	50	19	808-412.019004				
G 3/4"A	55	13	808-412.013006	G 3/4"	45	13	808-402.013006
G 3/4"A	55	19	808-412.019006	G 3/4"	45	19	808-402.019006
G 3/4"A	55	25	808-412.025006				
G 1"A	60	19	808-412.019008	G 1"	45	19	808-402.019008
G 1"A	60	25	808-412.025008	G 1"	45	25	808-402.025008
G 1-1/4"A	75	25	808-412.025010	G 1-1/4"	52	25	808-402.025010

weitere Abmessungen auf Anfrage / other sizes on request

SCHLAUCHTÜLLEN BSPT EN 10226-1 (DIN 2999)
HOSE NIPPLES British Standard Pipe Taper

BETRIEBSDRUCK 1,0 MPa (10 bar)
EINBAND Schlauchschelle
WORKING PRESSURE 1,0 MPa (10 bar)
ASSEMBLING hose clamp

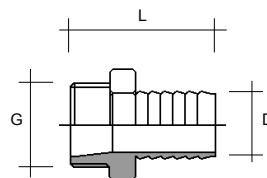

konisches Außengewinde / tapered thread

Edelstahl / stainless steel 1.4571

Schlauchtülle / hose nipple

G BSPT	L mm	D mm	Art.-Nr.	G BSPT	L mm	D mm	Art.-Nr.
R 1/4"	38	6	808-422.006002	R 1"	65	13	808-422.013008
R 1/4"	40	8	808-422.008002	R 1"	68	19	808-422.019008
R 1/4"	45	9	808-422.009002	R 1"	68	25	808-422.025008
R 1/4"	47	11	808-422.011002	R 1"	68	32	808-422.032008
R 3/8"	50	6	808-422.006003	R 1-1/4"	68	16	808-422.016010
R 3/8"	50	9	808-422.009003	R 1-1/4"	68	19	808-422.019010
R 3/8"	50	11	808-422.011003	R 1-1/4"	75	25	808-422.025010
R 3/8"	50	13	808-422.013003	R 1-1/4"	75	30	808-422.030010
R 1/2"	52	6	808-422.006004	R 1-1/4"	75	32	808-422.032010
R 1/2"	52	9	808-422.009004	R 1-1/4"	75	40	808-422.040010
R 1/2"	52	11	808-422.011004	R 1-1/2"	75	25	808-422.025012
R 1/2"	52	13	808-422.013004	R 1-1/2"	80	32	808-422.032012
R 1/2"	62	16	808-422.016004	R 1-1/2"	80	38	808-422.038012
R 1/2"	54	19	808-422.019004	R 1-1/2"	80	40	808-422.040012
R 3/4"	55	10	808-422.010006	R 2"	82	40	808-422.040016
R 3/4"	58	13	808-422.013006	R 2"	82	50	808-422.050016
R 3/4"	58	16	808-422.016006				
R 3/4"	58	19	808-422.019006				
R 3/4"	58	25	808-422.025006				

weitere Abmessungen auf Anfrage / other sizes on request

SCHLAUCHTÜLLEN NPT ANSI B 1.20.1
HOSE NIPPLES *National Pipe Taper*

BETRIEBSDRUCK 1,0 MPa (10 bar)
EINBAND Schlauchschelle
WORKING PRESSURE 1,0 MPa (10 bar)
ASSEMBLING hose clamp

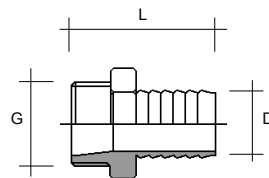

konisches Außengewinde / tapered thread

Edelstahl / stainless steel 1.4571

Schlauchtülle / hose nipple

G NPT	L mm	D mm	Art.-Nr.	G NPT	L mm	D mm	Art.-Nr.
1/4"	46	6	808-432.006002	3/4"	62	13	808-432.013006
1/4"	46	8	808-432.008002	3/4"	62	16	808-432.016006
1/4"	46	10	808-432.010002	3/4"	62	19	808-432.019006
1/4"	50	11	808-432.011002	3/4"	62	25	808-432.025006
3/8"	50	6	808-432.006003	1"	70	19	808-432.019008
3/8"	50	9	808-432.009003	1"	70	25	808-432.025008
3/8"	50	11	808-432.011003	1"	70	32	808-432.032008
3/8"	50	13	808-432.013003	1-1/4"	80	32	808-432.032010
1/2"	58	6	808-432.006004	1-1/4"	80	40	808-432.040010
1/2"	58	9	808-432.009004	1-1/2"	80	32	808-432.032012
1/2"	58	11	808-432.011004	1-1/2"	80	40	808-432.040012
1/2"	58	13	808-432.013004	2"	85	40	808-432.040016
1/2"	58	16	808-432.016004	2"	85	50	808-432.050016
1/2"	58	19	808-432.019004				

weitere Abmessungen auf Anfrage / other sizes on request